

METECH DOORS

An ISO 9001 : 2008 Certified Company

METAL DOOR SPECIALIST SINCE 1989



About our company and door



METECH KENZAI SDN.BHD. (180881-U) Established in 1989 from a Joint Venture with SANWA Shutter Corp. Japan, (the world's largest manufacturer of steel doors) and SIN KEAN BOON Group Berhad. Today the company has now become a wholly owned subsidiary of SKIB CAPITAL GROUP.

Our highly focused R&D facilities enable us to manufacture shutter & door products with some of the most stringent specifications to meet the security and protection needs for the most demanding industries.

With a team of skilfully trained engineers and technicians coupled with our sophisticated 6500m2 manufacturing plant located in Penang, Malaysia. Our factory is fully equipped with the state of the art manufacturing equipment to cater for high capacity production.

METECH KENZAI also produces a full range of door and shutter system for the rapid growing demand of a vast range of industries both locally in Malaysia and also abroad. We believe that with a strong customer and sales network, we can continue to thrive to become a major manufacturer of specialized door system in Malaysia

Frame Profiles

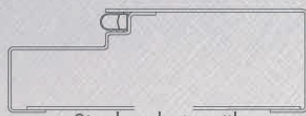

Single rebate with rubber gasket



Double rebate with rubber gasket



Double rebate standard



Single rebate standard

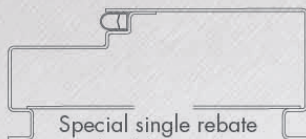

Special single rebate with rubber gasket

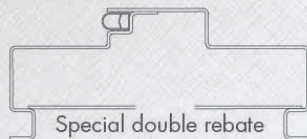

Special double rebate with rubber gasket



Special double rebate standard

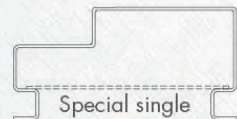

Special single rebate standard



Special single rebate with rubber gasket

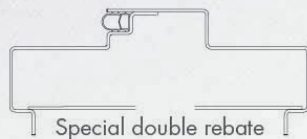

Special double rebate with rubber gasket



Special double rebate standard

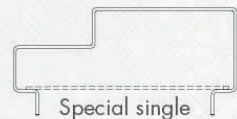

Special single rebate standard

Bottom Sill Profiles



Standard "C"

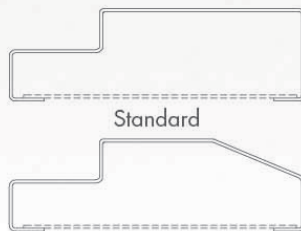

Standard

Standard with slope

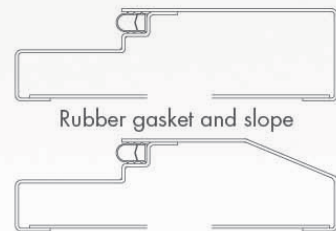

Rubber gasket and slope

Rubber gasket and slope

Steel Door

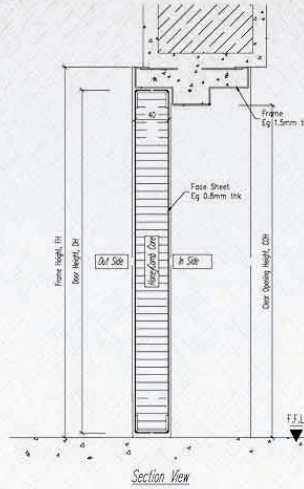
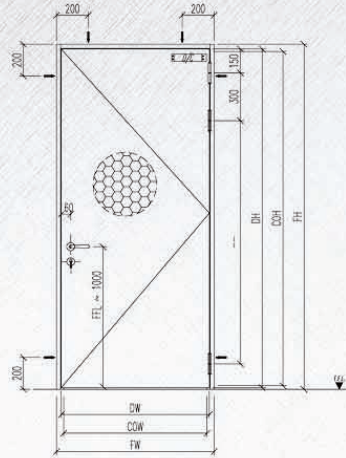
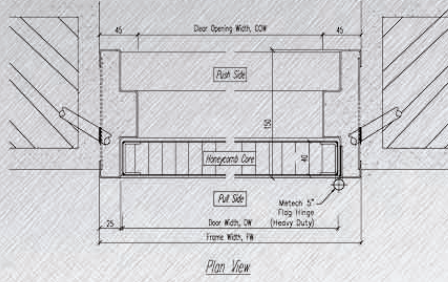

HCC (Honey Comb Core Type)

Specifications

Door type

METECH Steel Flush Door (edge type)

Frame type

METECH Type 45x125x1.5mm THK EG Steel

Panel type

Honey Comb Infill Core

Hinge type

METECH Stainless Steel 5" Flag Hinge

Lockset type

To customer requirement

Face sheet

0.8 THK EGG Sheet

Flush bolt

Metech Standard Stainless Steel
(Double Leaf Only)

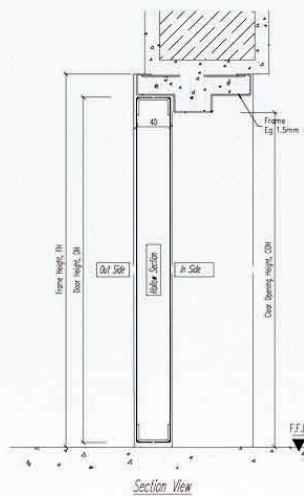
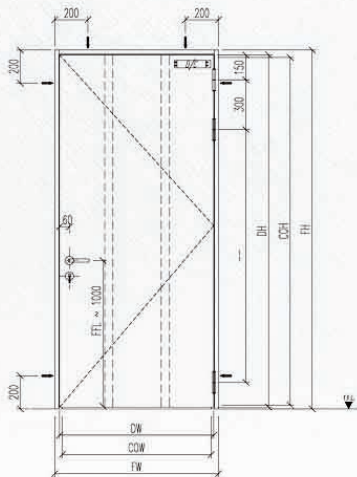
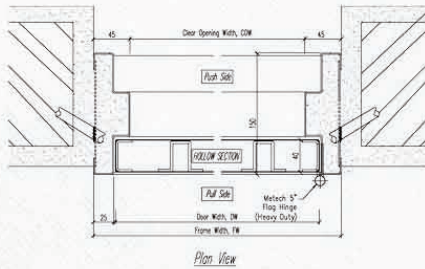

SD (Hollow Section Type)

Specifications

Door type

METECH Steel Flush Door (no edge type)

Frame type

METECH Type 45x125x1.5mm THK EG Steel

Panel type

Hollow section (panel thickness 40mm)

Hinge type

METECH Stainless Steel 5" Flag Hinge

Lockset type

To customer requirement

Face sheet

1.2 THK EGG Sheet

Flush bolt

Metech Standard Stainless Steel
(Double Leaf Only)

(British Standard BS 476 : Part 22 : 1987 (Fire rated))

Fire Rated Steel Door

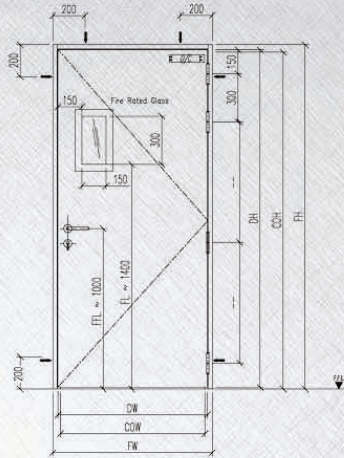
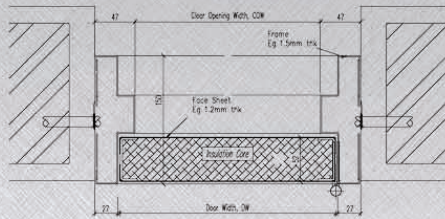

Front Elevation View

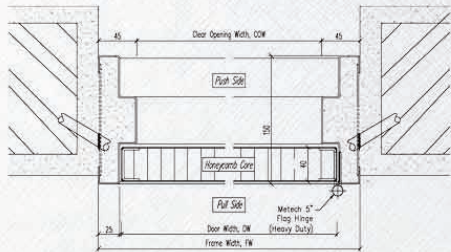

Plan View

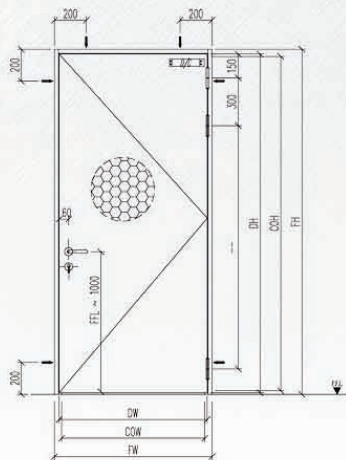

Elevation View

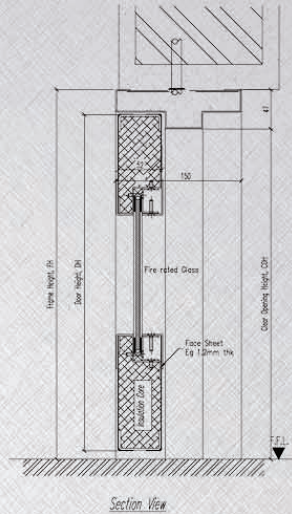

Section View

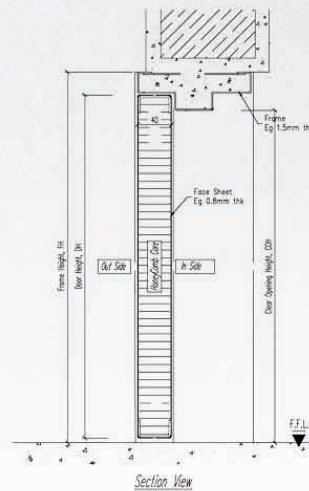

Section View

Insulated Fire Door

Specifications

(with or without vision panel, 1 hour and 2 hours fire rating)

1 Hour

- Made of Electro-galvanized steel
- Standard Frame (depth - 150mm, thickness - 1.5mm)
- Standard Panel (face sheet thickness from 1.2mm)
- Standard Panel (thickness - 50mm)
- Hard wares tested for fire resistant (SIRIM and BOMBA approved)

2 Hours

- Made of Electro-galvanized steel
- Standard Frame (depth - 150mm)
- Standard Panel (face sheet thickness from 1.2mm)
- Standard Panel (thickness - 50mm)
- Hard wares tested for fire resistant (SIRIM and BOMBA approved)

Non-insulated Fire Door

Specifications

(1 hour, 2 hours and 4 hours fire rating, **British & Singapore Standard**)

- Made of Electro-galvanized steel
- Infill type - honey comb/hollow/rock wool
- Panel thickness - from 36mm onwards
- Panel face sheet thickness - from 0.8mm onwards
- Door frame (single/double rebated) thickness - 1.5mm
- Frame depth - 150mm



Metech Insulated Fire Steel Doors

Designed to Malaysia Standard fire doors. It has the advantage of reliability in quality and low in maintenance after installation. It does not warp over time and all materials are recyclable which contribute towards green buildings index.

Fire Resistant

Approved 1 and 2 hours by Bomba Malaysia MS 1073 : PART 3 : 1996

Door Frame

Fabricated from first grade galvanised steel of 1.5mm thickness. Reinforced backplated and protection cover for hinges, door closers and locksets striker plates. Cap with ceramic board for maximum insulation purpose.

Door Panel

Fabricated from first grade galvanised steel of 1.2mm thickness with insulated core. Reinforced plates for hinges, door closers and lockset are provided as standard intumescent seal are installed for extra safety.

Vision Panel

Constructed with first grade galvanised steel frame capping and fixed with 5.0mm compartment lite fire rated glass. The gaps between the glass and capping stiffener is lined with a layer of ceramic board. Standard size : Width 150mm x Height 300mm

Finishing

One coat of anti rust primer as standard finishing.

Metech Industry Steel Doors (Non fire rated)

Developed to provide elegant outlook, better security for buildings and eco friendly environment.

Door Frame

Fabricated from first grade galvanised steel with door bumpers. Reinforced backplates and protection cover for hinges, door closers and locksets striker plates.

Optional Feature

- Air tight gasket around frame.
- Stainless steel bottom threshold

Door Panel

Constructed from 2 pieces of 0.8mm galvanised steel sheets with recyclable paper honey comb core or polyether Pu foam in-filled to form a 40mm thick panel.

Reinforced steels channels for panel and backplates for hinges, door closer and lockset are provided.

Vision Panel

Constructed with first grade galvanised steel frame capping and stiffeners type of glazing and size of view panel tailored to customer request.

Finishing

One coat of anti rust primer as standard finishing.

RECENTLY COMPLETED MAJOR PROJECTS

Infineon Expansion Project, Kulim Hi-Tech
 B.braun B10 Package, Penang
 B.braun B11 Package, Penang
 Perodua New Plant, Rawang
 Toyo Tyre, Taiping
 The Store Kb Mall, Kota Bahru
 The Store Taiping Mall, Taiping
 Manjung Power Plant, Manjung
 Sunshine Hypermarket, Bertam
 Acm, Bukit Kayu Hitam
 Istana Terengganu, Malaysia
 Hershey Malaysia, Johor
 Honda, Batu Kawan
 Ota Tunnel, Perak
 Gurney Paragon, Penang
 Exxon Mobile Pnglng, Papua New Guinea
 Mal, Batu Kawan
 Gemesis, Batu Kawan
 Vat, Batu Kawan
 Western Geco, Penang
 First Solar, Kulim Hi-Tech
 Ibliden, Penang
 Pensonic, Penang
 Western Digital, Johor

MAJOR PROJECTS COMPLETED

Kl International Airport, Malaysia
 Jimah Power Plant, Port Dickson, Malaysia
 Titan Petchem, Pasir Gudang, Malaysia
 Kl Hilton, Kuala Lumpur
 Tuanku Jaafar Power Station, Seremban, Malaysia
 Ijm, Troika, Kuala Lumpur
 Petronas Sungai Udang, Melaka
 Gurney Plaza, Penang
 Queensbay Mall, Penang
 Kl International Airport, Kuala Lumpur
 Great Eastern Tower, Penang & Kuala Lumpur

University Technology Petronas
 Hilton Hotel, Kuala Lumpur
 Infineon, Kedah
 Motorola Plant, Penang
 Public Bank (Hq), Selangor
 Seagate, Johor
 Ciba Vision, Johor
 Toyota Auto Body, Shah Alam
 Tudm, Kedah
 Isetan, Mid Valley, Kuala Lumpur
 Jimah Power Station, Port Dickson
 Sharp Roxy & Electronics, Selangor
 University Malaya Hospital, Kuala Lumpur
 Tuanku Jaafar Power Station, Seremban
 Gleneagles Medical Centre, Penang
 Troika Condominium, Kuala Lumpur
 Ibliden, Penang
 Sabah & Sarawak Gas Pipeline, East Malaysia
 Tokuyama Tmp Ii, Bintulu
 Om Sarawak Ferroalloy Smelter Project, Bintulu Sarawak
 Murum Hydroelectric Power Station Kapit Division, Sarawak

SINGAPORE

Toshiba
 One Raffles Quay
 New Supreme Court
 World Trade Centre
 Boulevard Station(S)
 Singapore Mrt Stations
 Exxomobil Chemical Asia Pasific
 Asia Tower 1, Singapore
 Jac Jurong Island, Singapore
 Exxon Mobile Parallel Train Project, Singapore
 Mapple Business Center

PAPUA NEW GUINEA

Exxon Mobil Png Lng, Papua New Guinea

VIETNAM

Canon, Vietnam
 Panasonic, Vietnam
 Tm Electronic, Vietnam
 National Archives Center, Vietnam
 Sumitomo Electric, Vietnam
 Hanoi Metal One, Vietnam
 Toyota Bo, Vietnam
 Iko Thompson, Vietnam
 Denso, Vietnam
 Chiyoda Integre, Vietnam
 Dung Quat Polyporpylene, Vietnam
 Canon Factory, Vietnam
 Korg, Vietnam
 Dung Quat Polypropylene Project, Vietnam

BRUNEI

Bling Power Plant, Brunei
 Brunei Shell Petroleum Project, Brunei
 Tutong Power Station, Brunei
 Battalion, Brunei
 Radio Television, Brunei

AFRICA

Djibouti Hotel, Africa

MALDIVES

Fw Construction, Maldives

SRI LANKA

Sri Langka Customs

BANGLADESH

Markasia

THAILAND

Diethelm

Manufactured Products: -

- Blast Resistant Window/Door (Swing/Sliding)
- Bullet Proof Window/Door (Swing/Sliding)
- Acoustic/Clean Room & Water Tight Door
- Fire Door (Up to 4 Hour Rating)
- Blast Proof & Bullet Proof Metal Doors
- Fire Rated Steel Doors (1, 2, & 4 Hrs) BS476 : Part 22 : 1987
- Insulated Fire Rated Steel Doors (1 & 2 Hrs) MS1073 : Part 3 : 1996
- Radiation Proof Doors
- Steel Doors
- Acoustic Doors
- High Speed Shutters
- Fire Rated Shutters 4Hrs (BS & MS Standards)
- Explosion Proof Shutters
- Insulated Roller Shutters
- Ceiling Suspension System
- Metal Fabricated Products

Factory and Sales / Marketing office

Metech Kenzai Sdn. Bhd. (180881-U)

formerly known as Sin Kean Boon-Sanwa (JV) S/B

Plot 11B Tingkat Perusahaan 6D,
Kawasan Perindustrian Prai 4
13600 Prai, Penang, Malaysia

Fax : 604 - 507 5200

Email : chris_sin@metech-kenzai.com

www.metech-kenzai.com

Agent/Distributor

Tel: 604 - 507 8998

